



## CANNON STREET ROAD, LONDON, E1

£2,250 PCM

\* PRIVATE TERRACE \* Goldman Greg are delighted to exclusively offer this two double bedroom split level apartment located on Cannon Street Road, E1.

The property benefits from two double bedrooms, a modern kitchen/diner and a separate living room with direct access onto an outdoor private terrace - perfect for the approaching summer months!

One of the benefits of living on Cannon Street Road is the convenience of local shops, bars/restaurants and other amenities all within a very short walk.

There's also a choice of buses and local stations close by including Shadwell, Limehouse, Tower Hill and Whitechapel all within very easy reach making this an excellent location for commuters in and out of the City.

Available to move into from the 18th April 2024, early viewings are highly recommended!



Cannon Street Road E1 0BH

Approx. Gross Internal Area = 78.3 sq m / 843 sq ft

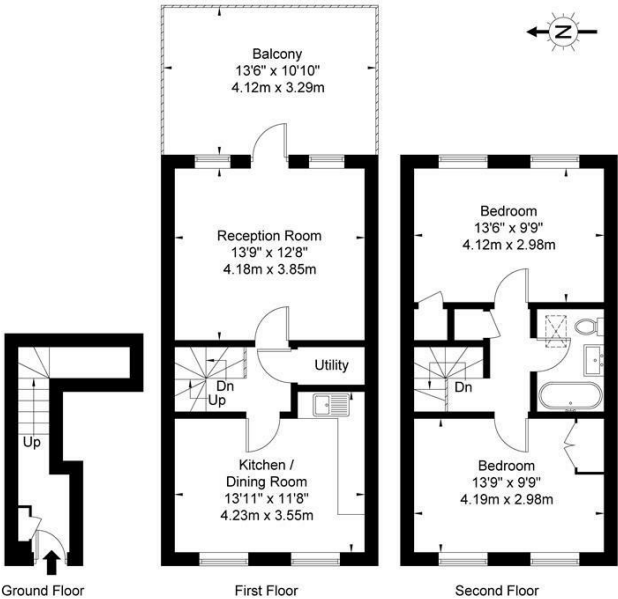

Ref Copyright BLEU PLAN

The Floor plan is not to scale and measurements and areas shown are approximate and therefore should be used for illustrative purposes only. The plan has been prepared in accordance with the RICS code of Measuring Practice and whilst we have confidence in the information produced it must not be relied on. If there is any aspect of particular importance, you should carry out or commission your own inspection of the property.

Copyright @ BLEUPLAN

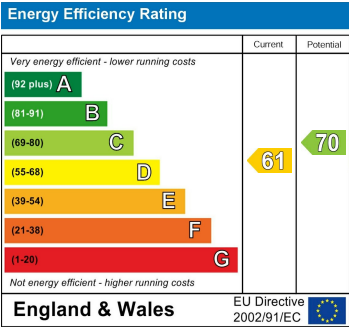
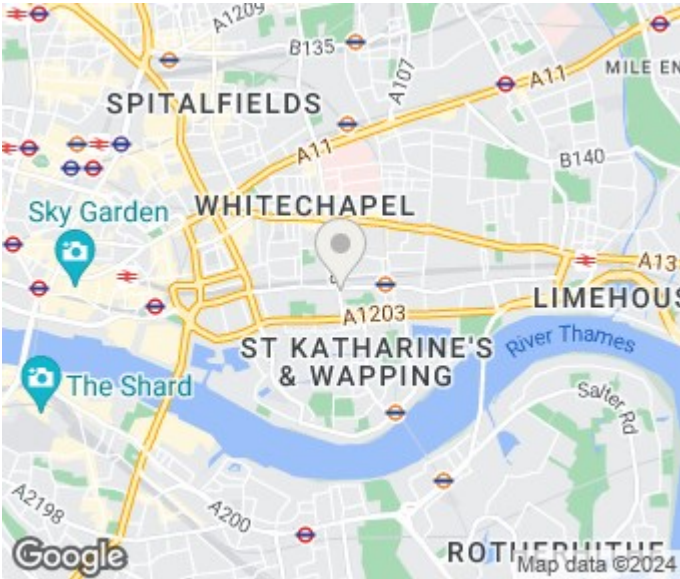

Agents Note: Whilst every care has been taken to prepare these particulars, they are for guidance purposes only. All measurements are approximate and are for general guidance purposes only and whilst every care has been taken to ensure their accuracy, they should not be relied upon and potential buyers/tenants are advised to recheck the measurements

Goldman Greg  
143 Leman Street  
London  
E1 8EY

02079770018  
leads@goldmangreg.co.uk  
www.goldmangreg.co.uk

